

PREPARED FOR  
SOMERSET CONDOS  
  
ORDERED BY  
ANGIE JAHNS

# PLAT OF SURVEY

- OF -  
Units 28-31, Somerset Condominium, located in Section 1  
Township 1 North, Range 17 East, in the City of Lake Geneva,  
Walworth County, Wisconsin.

PATHFINDER SURVEYING  
(a NMB Company)  
P.O BOX 322  
LAKE GENEVA, WI. 53147  
WWW.PATHFINDERSURVEYING.NET  
262-248-8303

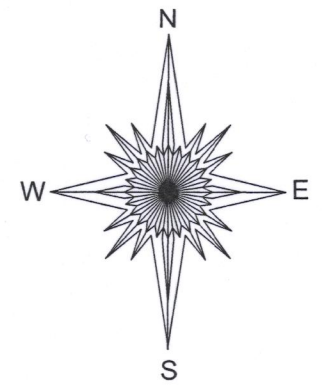

LAGRANGE DRIVE  
(66' WIDE)

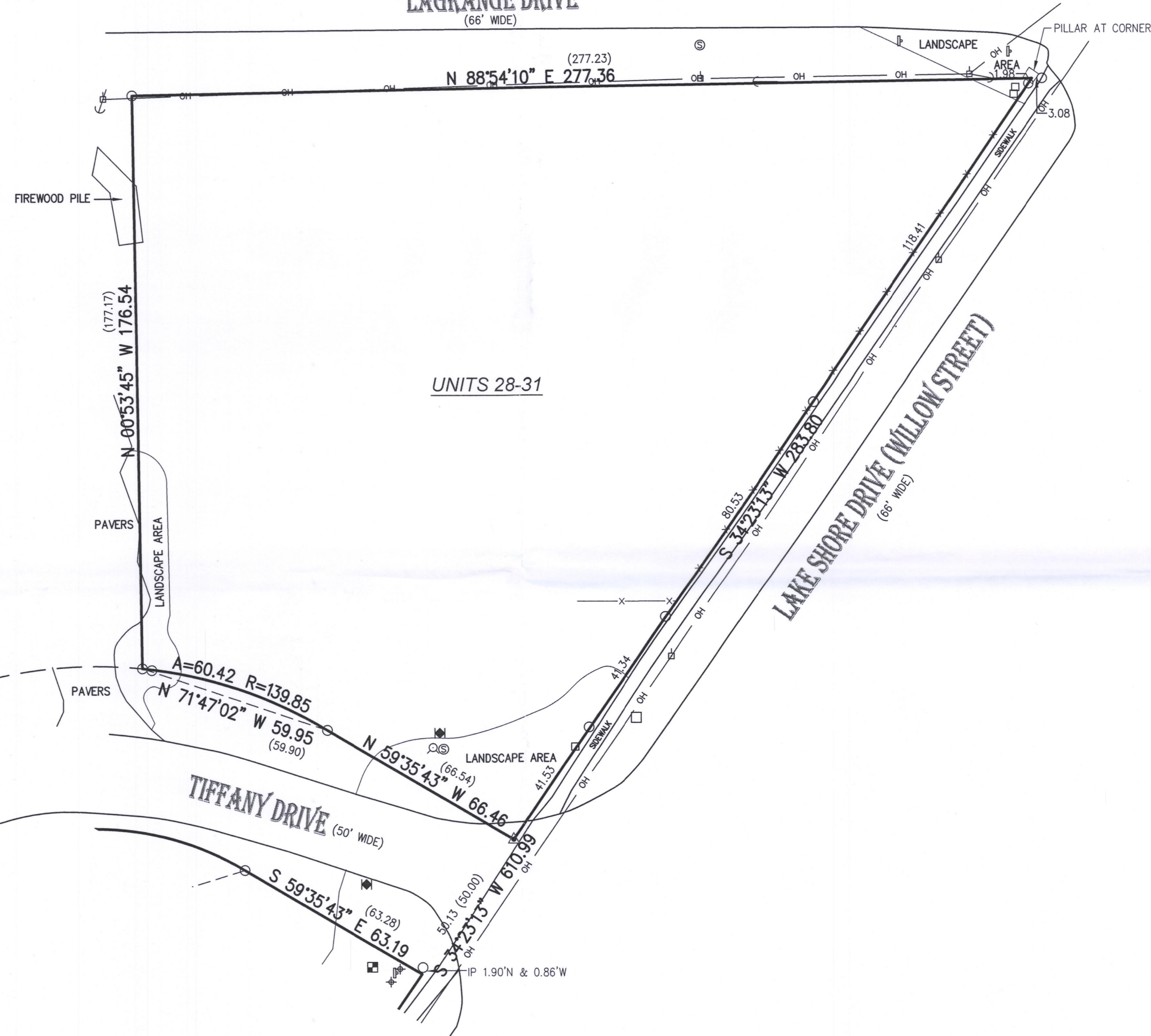

30 0 30 60 90

BASIS OF BEARING OF THIS PLAT: THE US STATE PLANE  
COORDINATE SYSTEM SOUTH ZONE, NAD 83. WISCORS.

I hereby certify that I have surveyed the above- described property and the  
above map is a true representation thereof and shows the size and  
location of the property, its exterior boundaries, the location and dimensions  
of all structures thereon, fences, apparent easements and roadways and  
visible encroachments if any to the best of my knowledge and belief.

This survey is made for the present owners of the property, and those who  
purchase, mortgage, or guarantee the title thereto, within one year from the  
date hereof.

DATED THIS 6th DAY OF AUGUST, 2018.



*Mark R. Madsen*  
MARK R. MADSEN S - 2271  
Wisconsin Professional Land Surveyor

- ( ) = recorded as
- = power pole
- = found iron pipe
- OH— = overhead wires
- = communication box
- = sign
- ⊙ = sanitary manhole
- = catchbasin
- = guy wire
- ⊕ = flood light
- X— = fence
- ⊠ = electric meter
- ⊠ = water control valve
- = pad mount transformer
- ⊙ = hydrant
- = set 5/8" rebar
- ▲ = set "pk" nail

SCALE 1" = 30'

JOB # 2018.0240.01

TAX ID # ZCNS 00028, ZCNS 00029, ZCSN 00030 & ZCNS 00031

ZCNS-28  
ZCNS-29  
ZCNS-30  
ZCNS-31

007-3520